

Mental Maps

Iowa City, Iowa 2012

© Robert E. Gutsche Jr.

Journalists

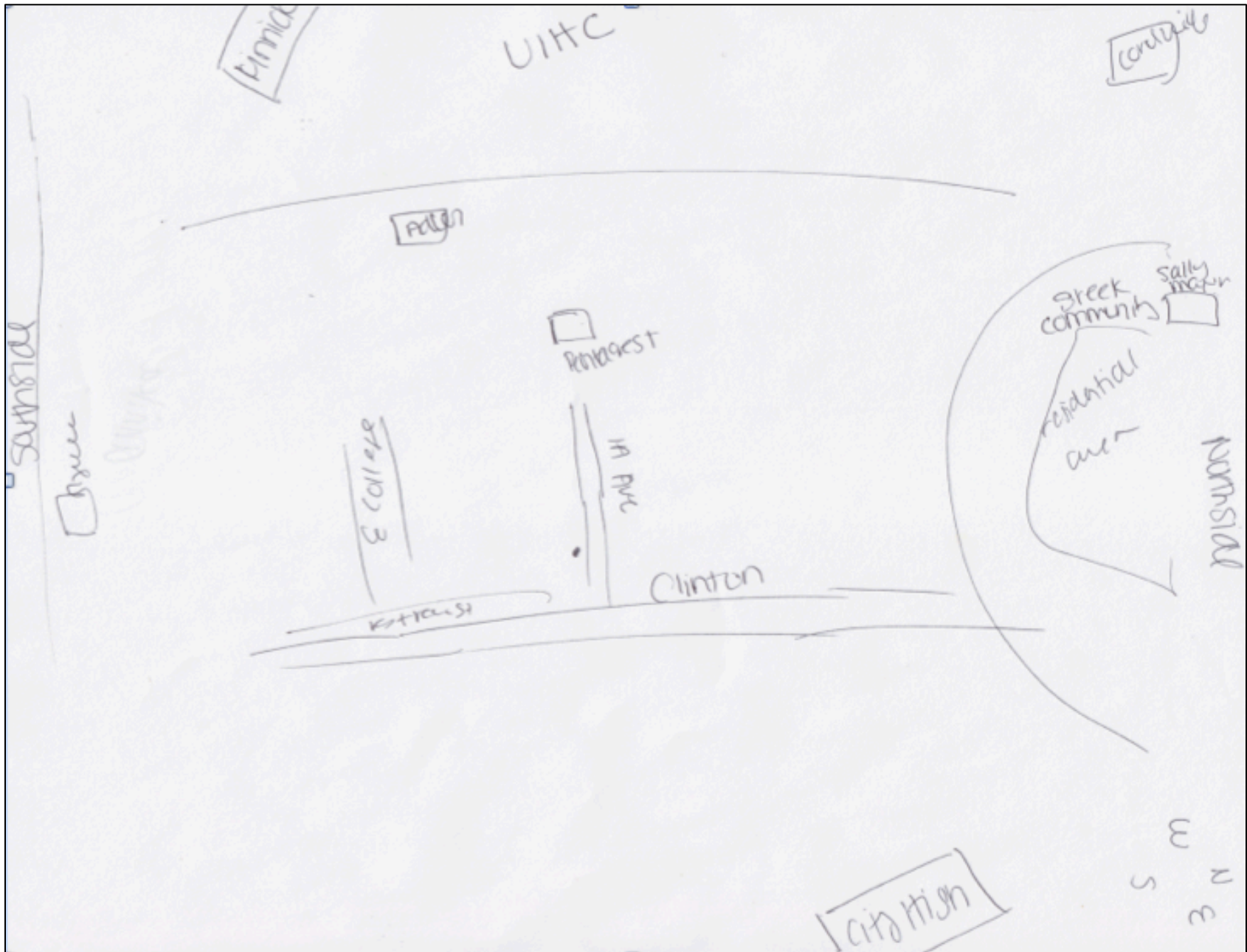

Annika's Map

Annika is a white college student journalist in Iowa City who has worked at *The Daily Iowan* for two years. She says that she spends most of her time in the city's downtown and does not have a car to see other parts of the city. On her map, she locates one of the city's three high schools, because she covered a story there once. Annika says that she has an idea about the North Side as being where students, professors, and the university president live. The center of Iowa City is the university's Pentacrest and Iowa Avenue, where Annika once lived. She said she drew the university building that houses the student newspaper because she spends most of her time there.

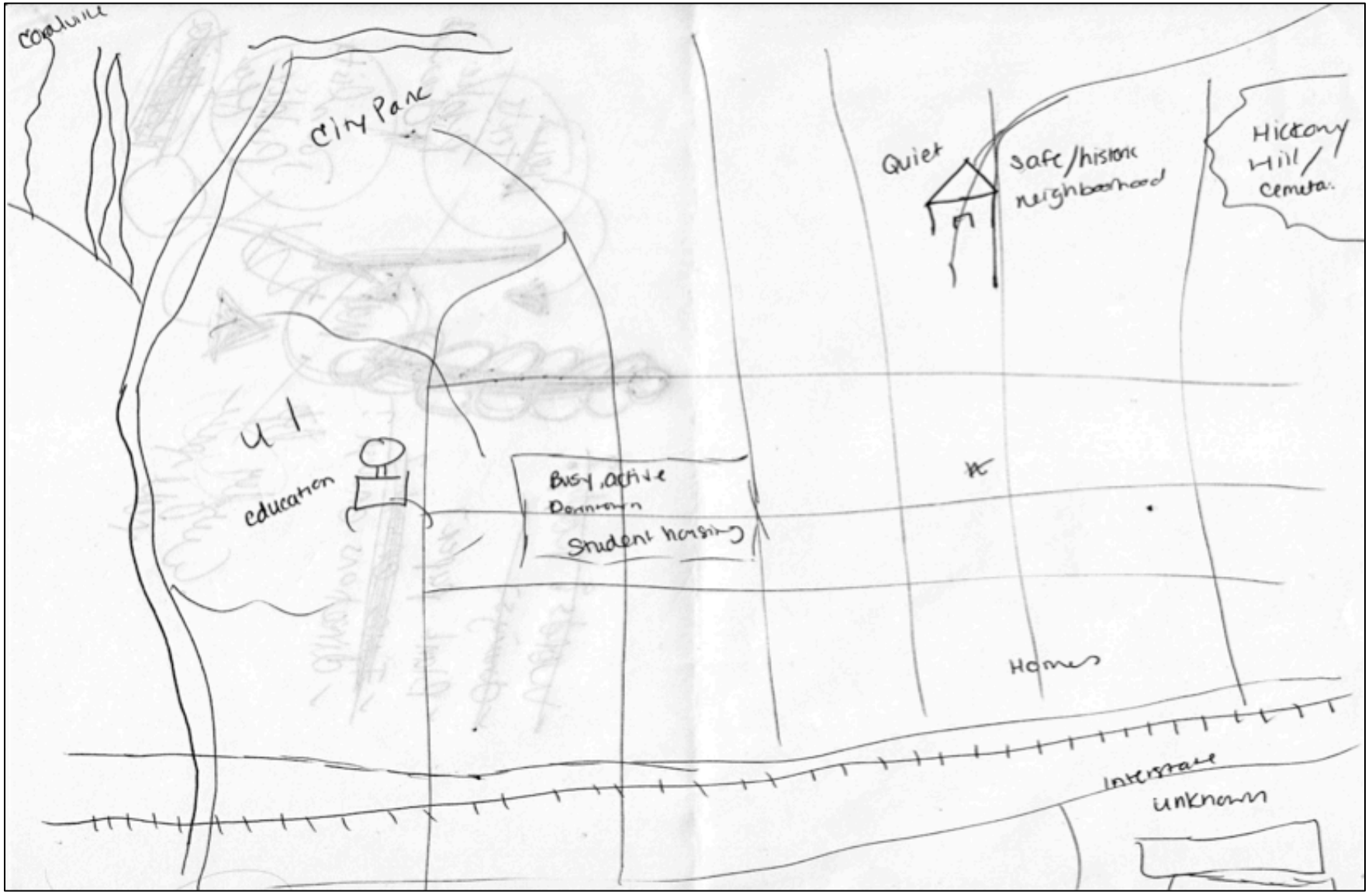

Ashley's Map

Ashley is a white college student journalist who has worked at *The Daily Iowan* for two years. Her map includes the university and larger public spaces, such as parks. Ashley says that she often drives to Coralville, a neighboring city, and she includes it in the northwest corner. She says that she wrote “unknown” in the southeastern corner, in part because she knew I was interested in her perspectives of that side of the city. The university is drawn inside a bubble, because the space is not very well defined, takes over a lot of space, and is an “entity” in that it imposes power over the community.

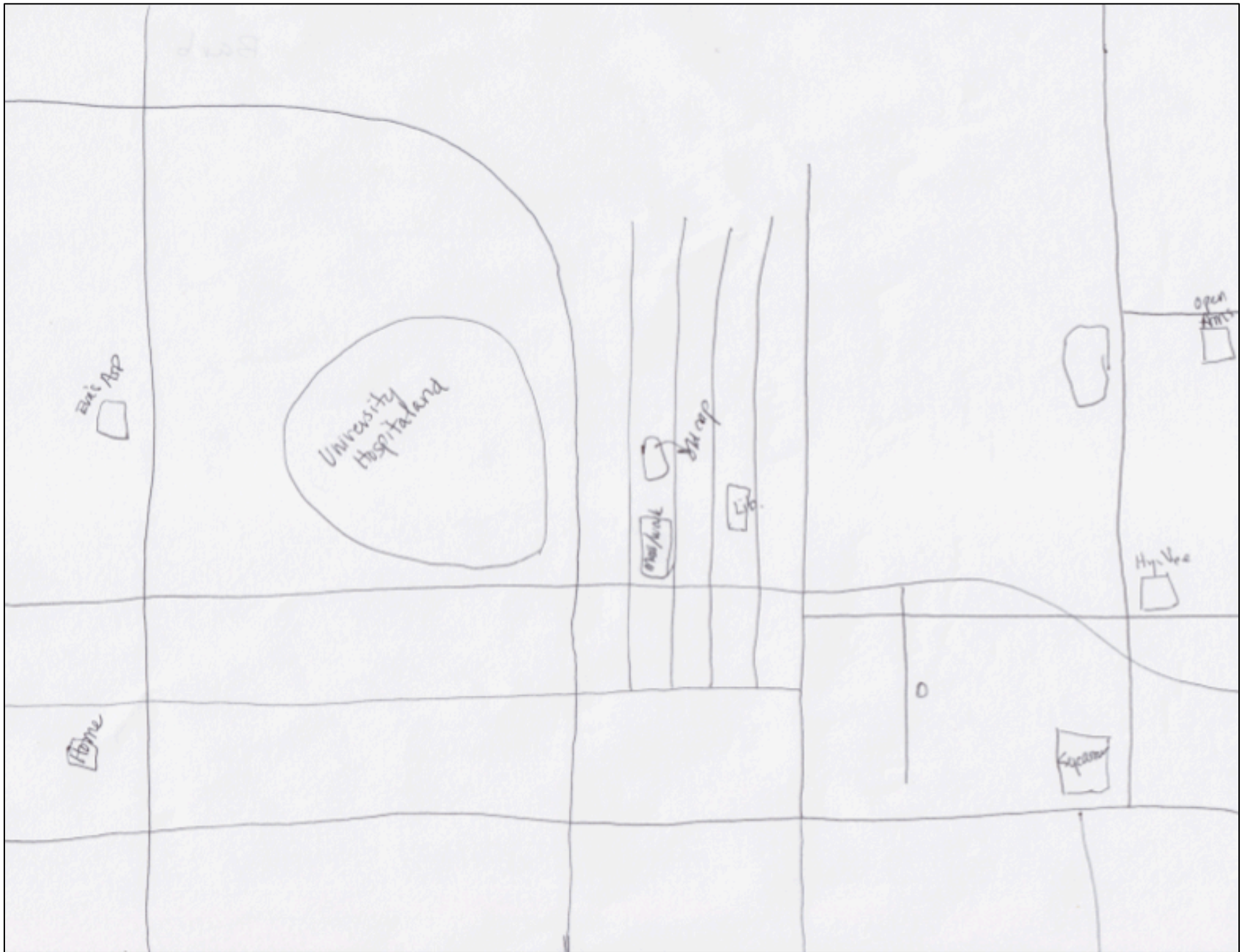

Barb's Map

Barb is a white reporter who has worked at two newspapers in the city for more than 11 years. She said she drew her map based on where she goes during a “regular day.” Barb, who lives on the West Side, works downtown. A large portion of the map is called “University Hospitaland,” where the university’s hospital is located.



David's Map

David is a white man who has lived in Iowa City since 1996. He attended college in Iowa City and has been a reporter at the *Press-Citizen* since 2005. He moved to Iowa City from near the Quad Cities. In Iowa City, David covered city government, and he constructs his ideas about the city in terms of journalistic beats. David thinks about housing, because he just bought a house in Coralville and added the courthouse and city hall, because he often reported from there. Other spaces where he reported are indicated in boxes on his map.

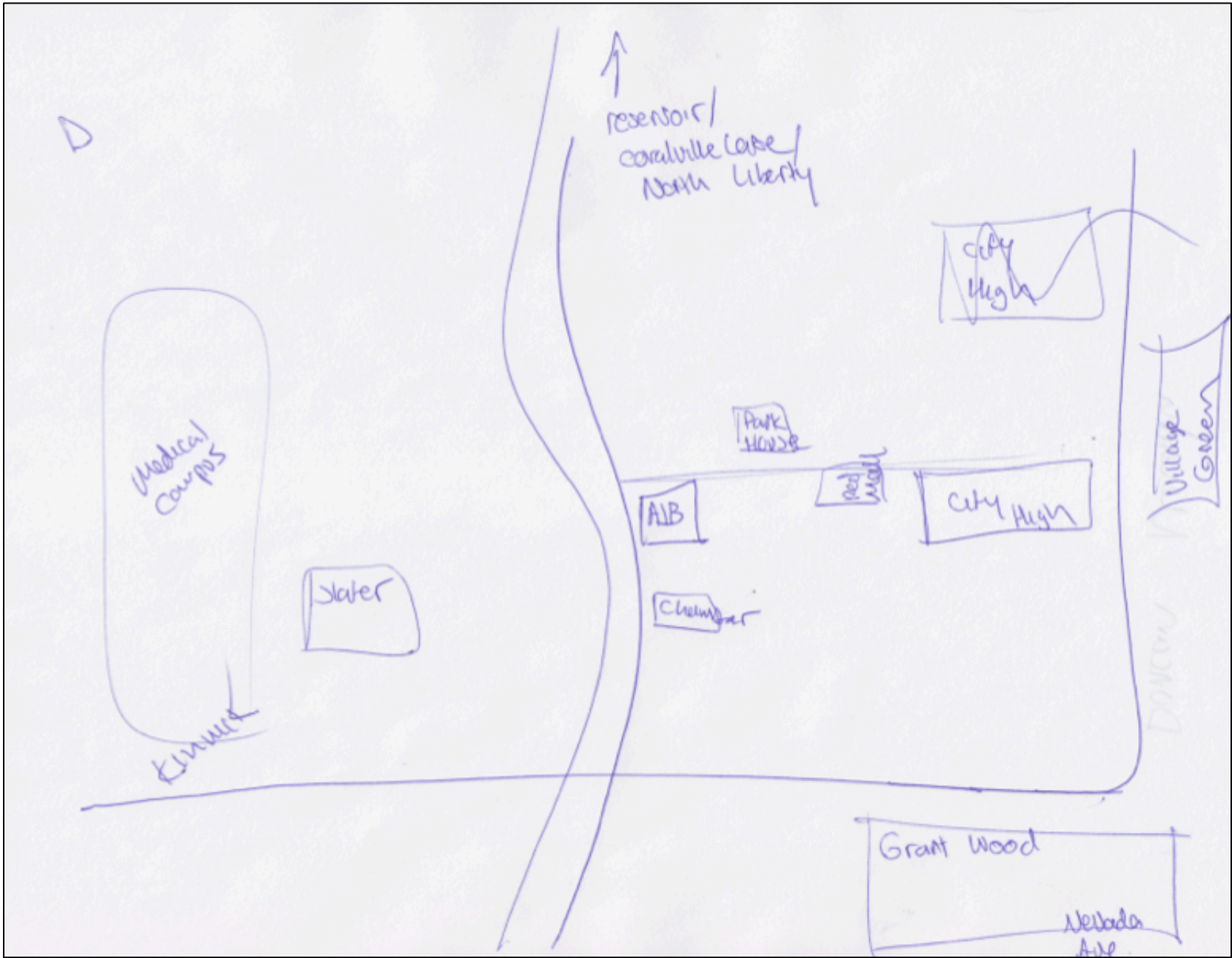

Duncan's Map

Duncan is a white reporter at *The Daily Iowan*. He has lived in Iowa City since birth and was raised on the "Southeast Side." On his map, Duncan marks all of the places in the city where he has lived. The West Side of the Iowa River contains the medical campus. He drew other particular places, as well, including university buildings. He also drew roads or lines to show places outside of Iowa City that he frequents.

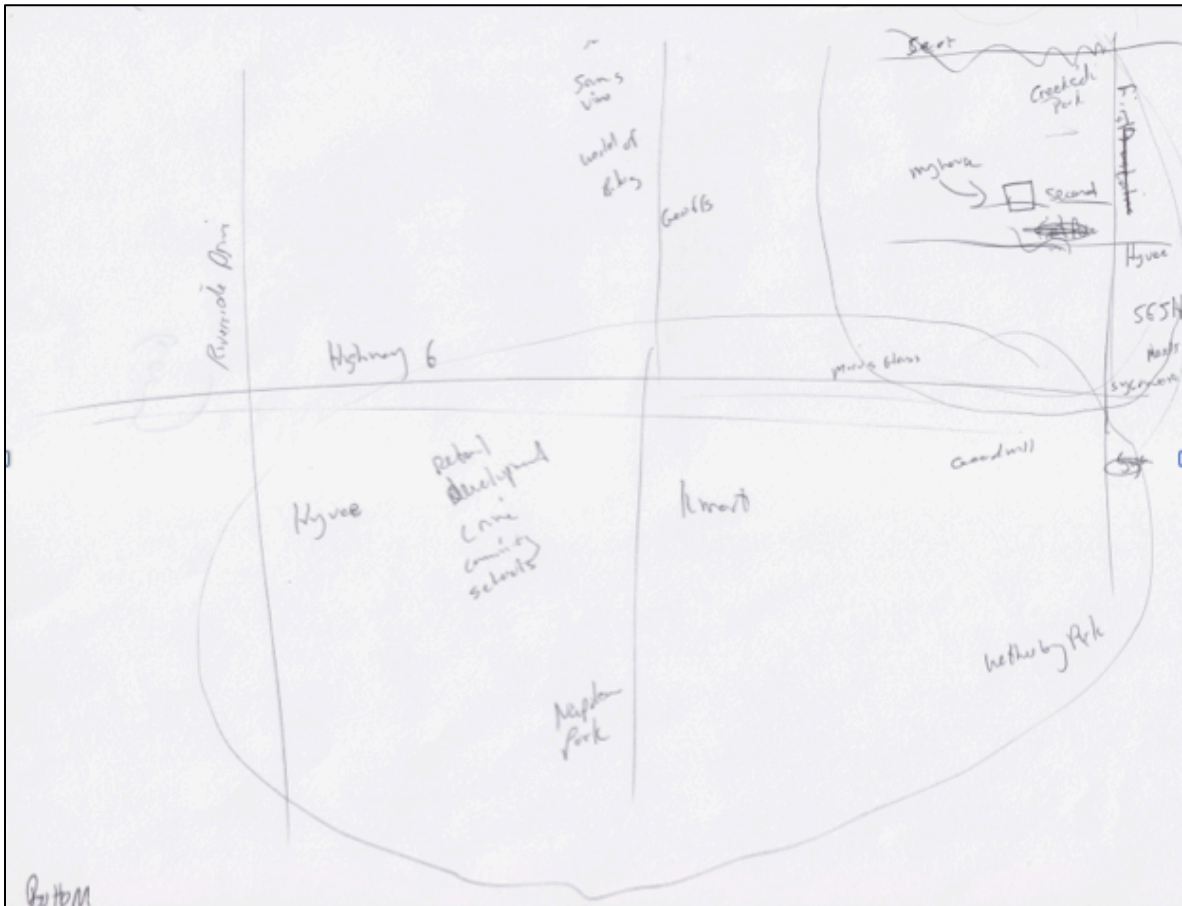
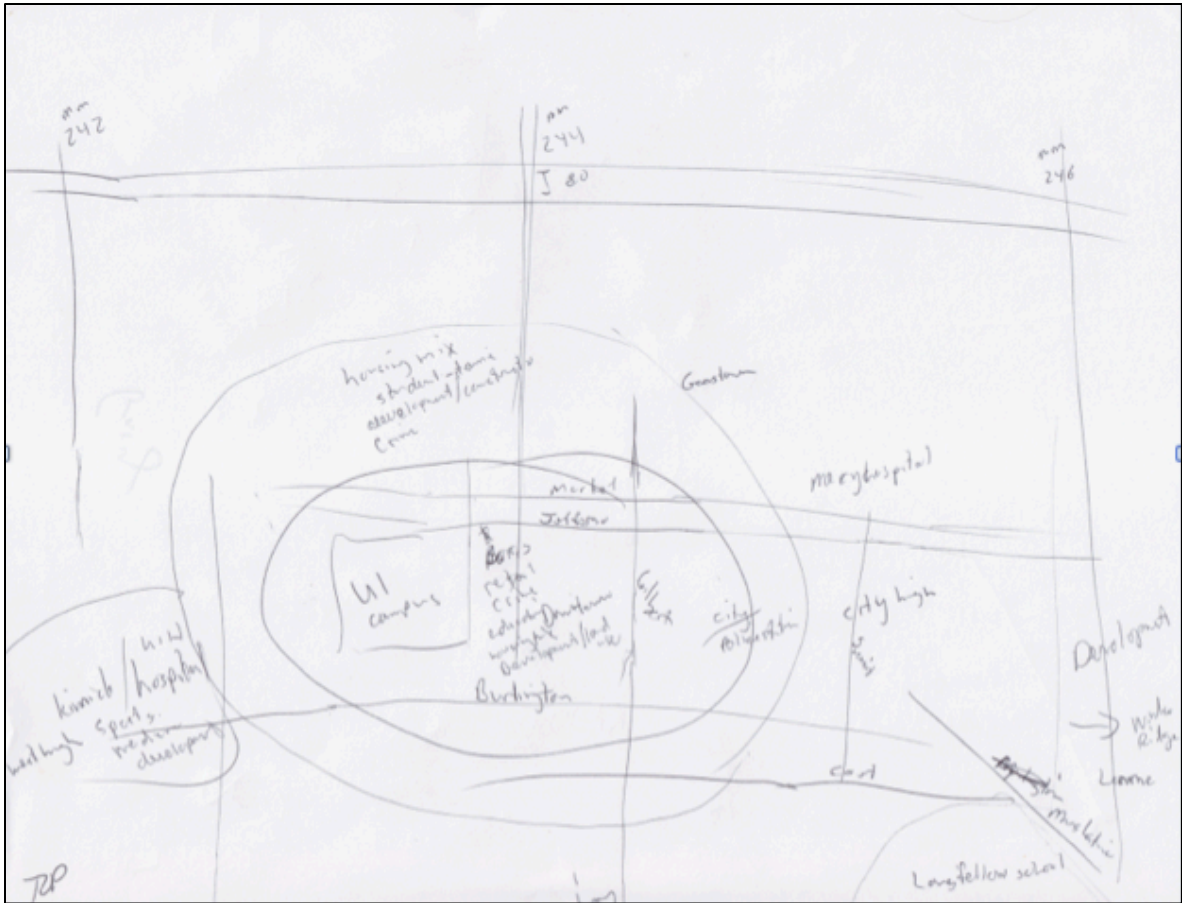

Gary's Map

Gary is a white reporter for the *Press-Citizen* who has been in Iowa City for 10 years. A father of two, he spends his time in his Southeast Side neighborhood. Gary is the only participant to use two pages for his map, in part because he wanted to show details and, more specifically, he wanted to discuss how reporters see the community. Each circle outside of the downtown has its own types of stories, dealing with different audiences. Reporting in the center circle deals with college students. The next circle contains neighborhood stories.

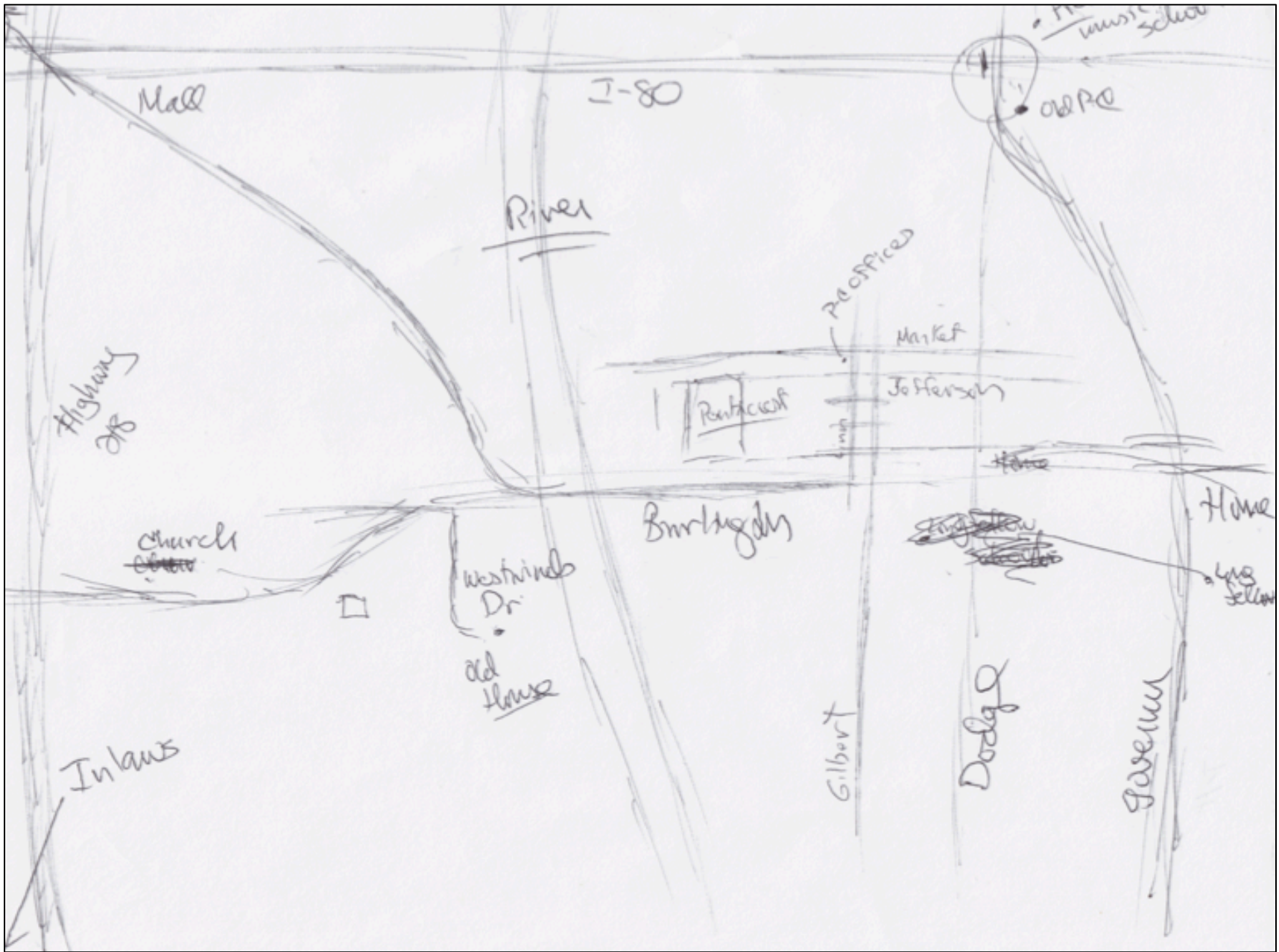

Jeff's Map

Jeff is a white reporter at the *Press-Citizen* who has lived in Iowa City for 13 years. He came to Iowa City from Chicago. Jeff shows specific streets that he uses to describe various neighborhoods. He places his old and new home on the map, the university Pentacrest, and he draws an arrow to where his in-laws live. He includes the shopping mall in a neighboring city and a music school north of Iowa City.

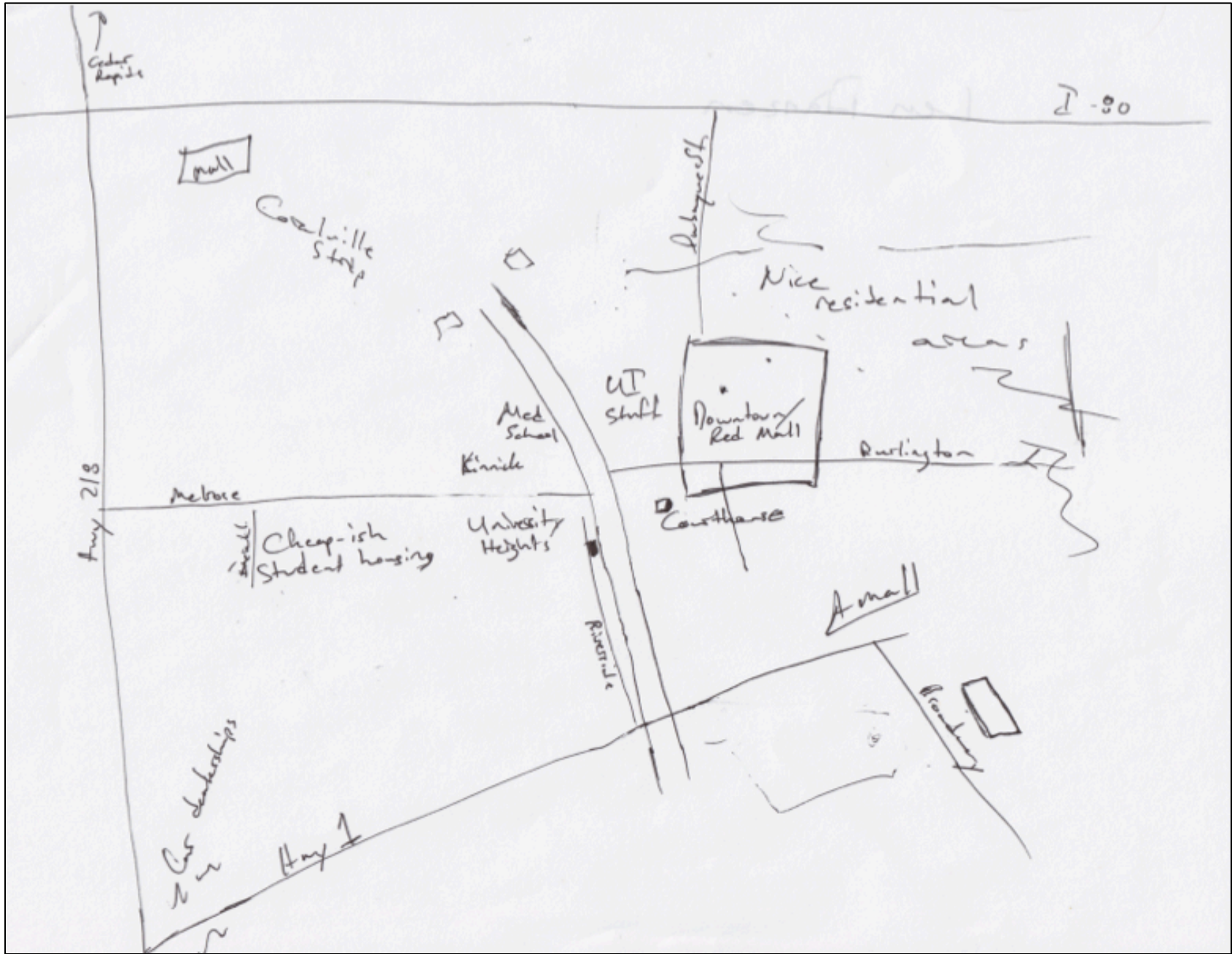

Len's Map

Len is a white reporter at *The Gazette* who uses his map to show class distinctions between neighborhoods in Iowa City. He writes that the Southwest Side is “cheapish student housing,” whereas the northeastern side is a “nice residential area.” He says he knows the downtown is close to “UI stuff” and that there are apartments on the Southeast Side. Len has never lived in Iowa City.

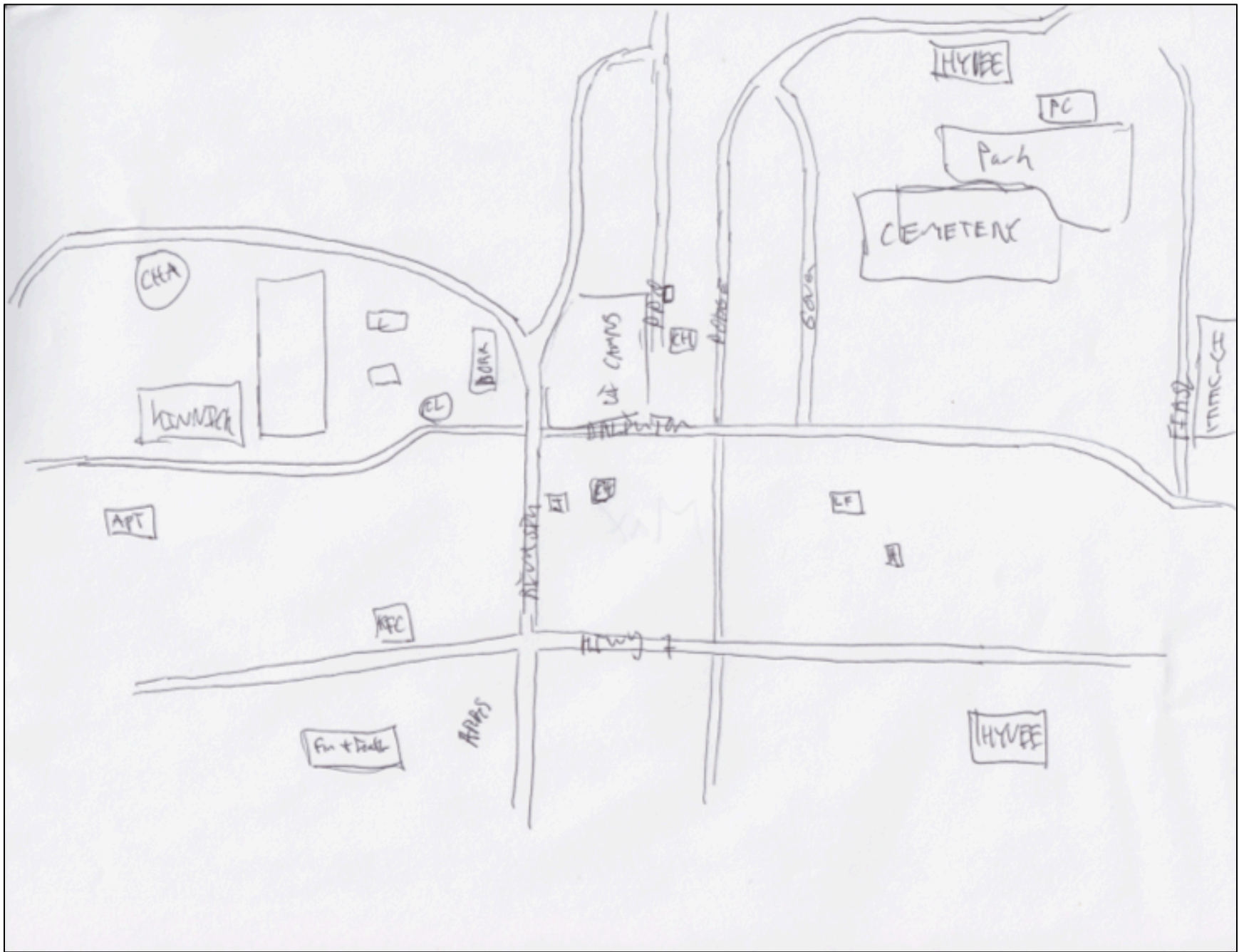

Max's Map

Max is a white reporter at the *Press-Citizen*. Max is very particular about his map, branching out from the Iowa River. His far northwest and southeastern sides are largely blank. At first, he says that he did not draw much there because the spaces are largely residential, but says that the West and East Sides are more detailed because he lived there in college and did not spend time in other spaces. He also locates his office, the university campus, and the university football stadium.

Roger is a Hispanic reporter for the *Press-Citizen* who has lived in Iowa City since 2003. Because he covered education, he locates many of the schools he visited. He places the university and the hospital in large circles and notes some of the businesses he visits, including Walmart. He also shows where some of his friends live. Roger lives on the West Side and pays attention to what he remembers seeing when he enters and exits the city's core.

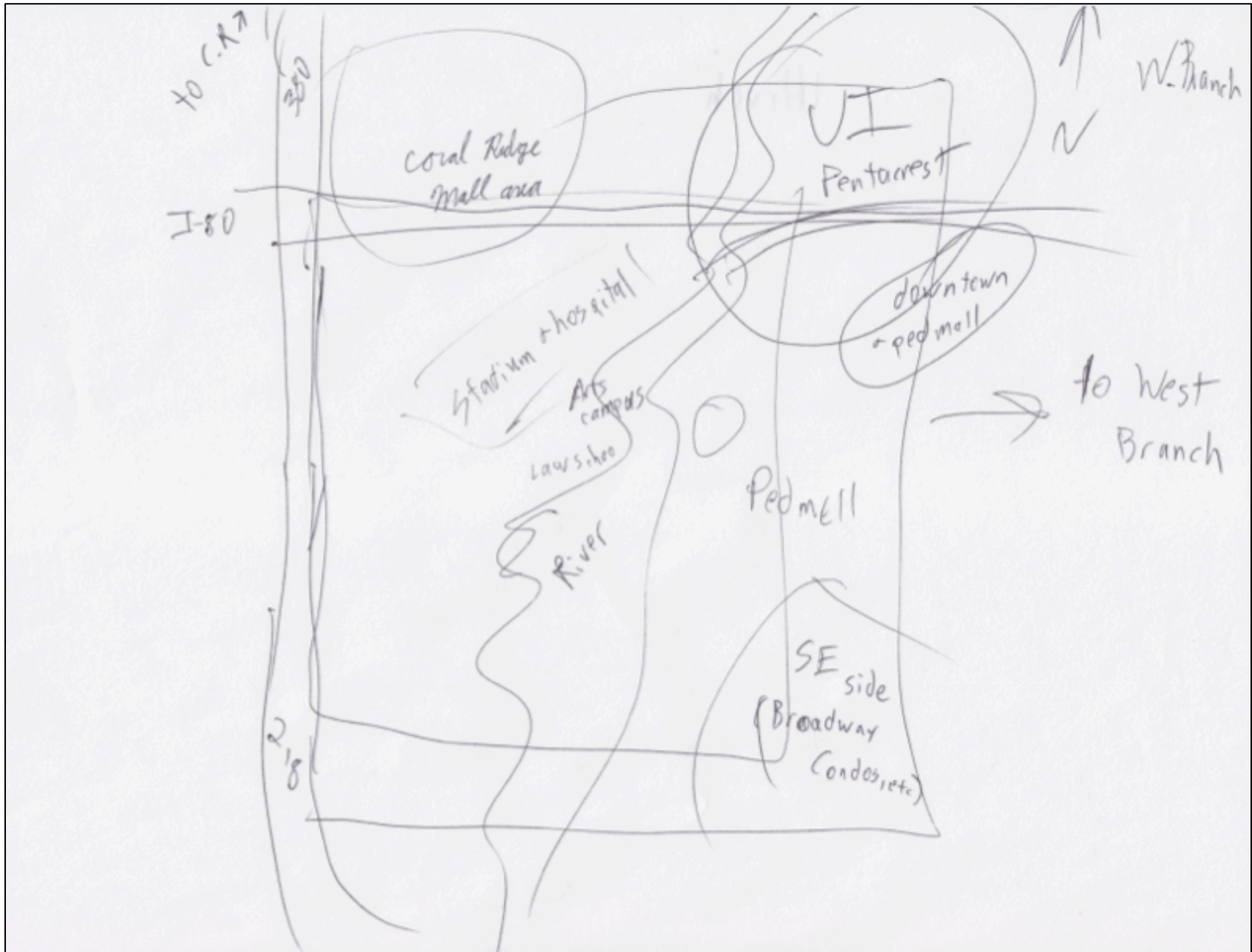

Ulrich's (aka Michael) Map

Ulrich is a white reporter for the *Press-Citizen* who moved to Iowa City in 2007. His map includes apartments on the Southeast Side, but the majority of the map shows some of the major corridors in and out of the city, including highways and interstates that take him to surrounding communities. The university, downtown pedestrian mall (“Ped mall”), football stadium, and hospital are also located on the map.