

# **Mental Maps**

**Iowa City, Iowa 2012**

© Robert E. Gutsche Jr.

## **Residents**

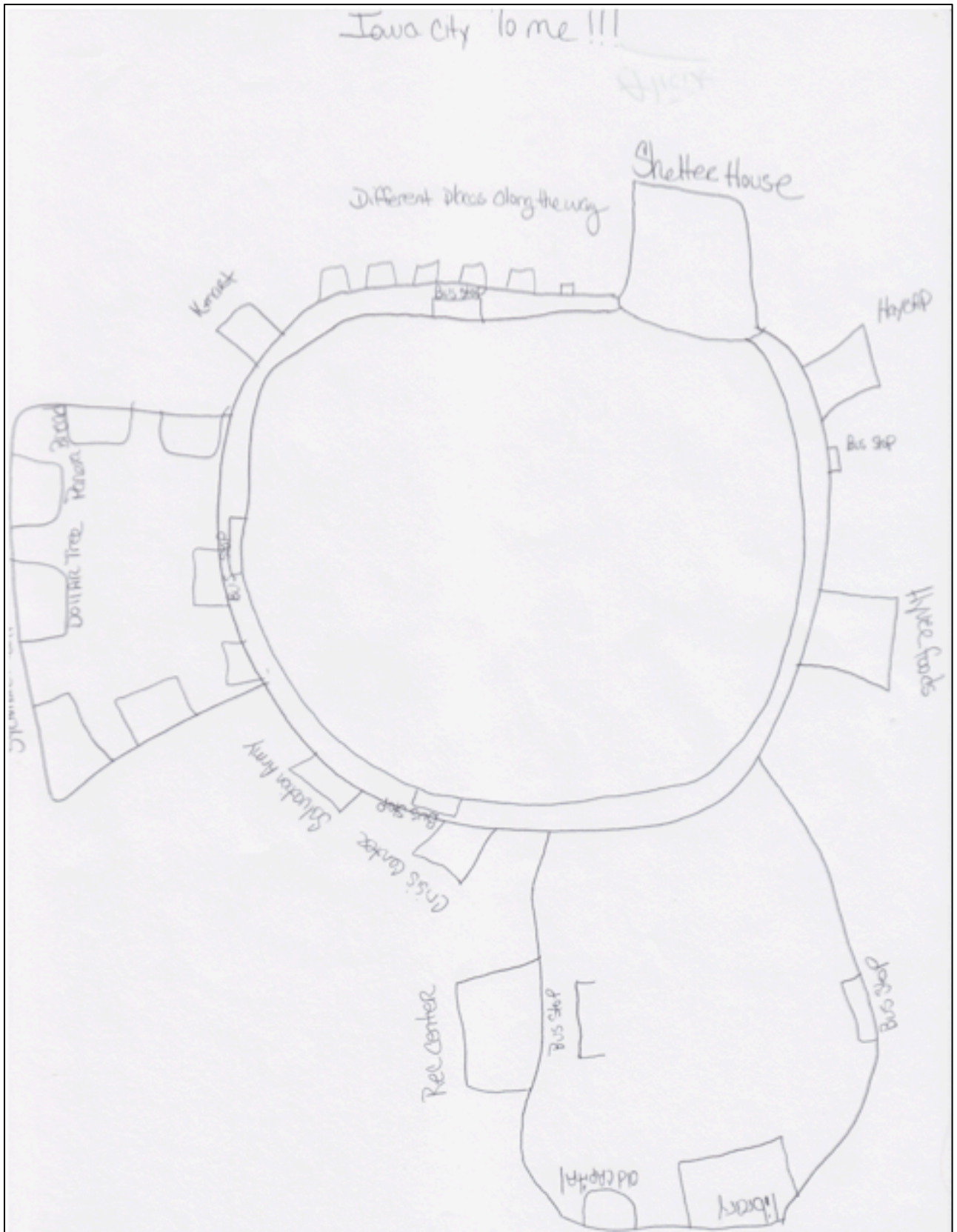

Alicia's Map

Alicia is a black woman from Chicago. Alicia stays in a homeless shelter with her five children. Her map of Iowa City follows the bus line, moving from the Shelter House homeless shelter to a nearby mall area where she works, then to Downtown. The far right of her map shows two other places she goes, including a grocery store and community resource facility.

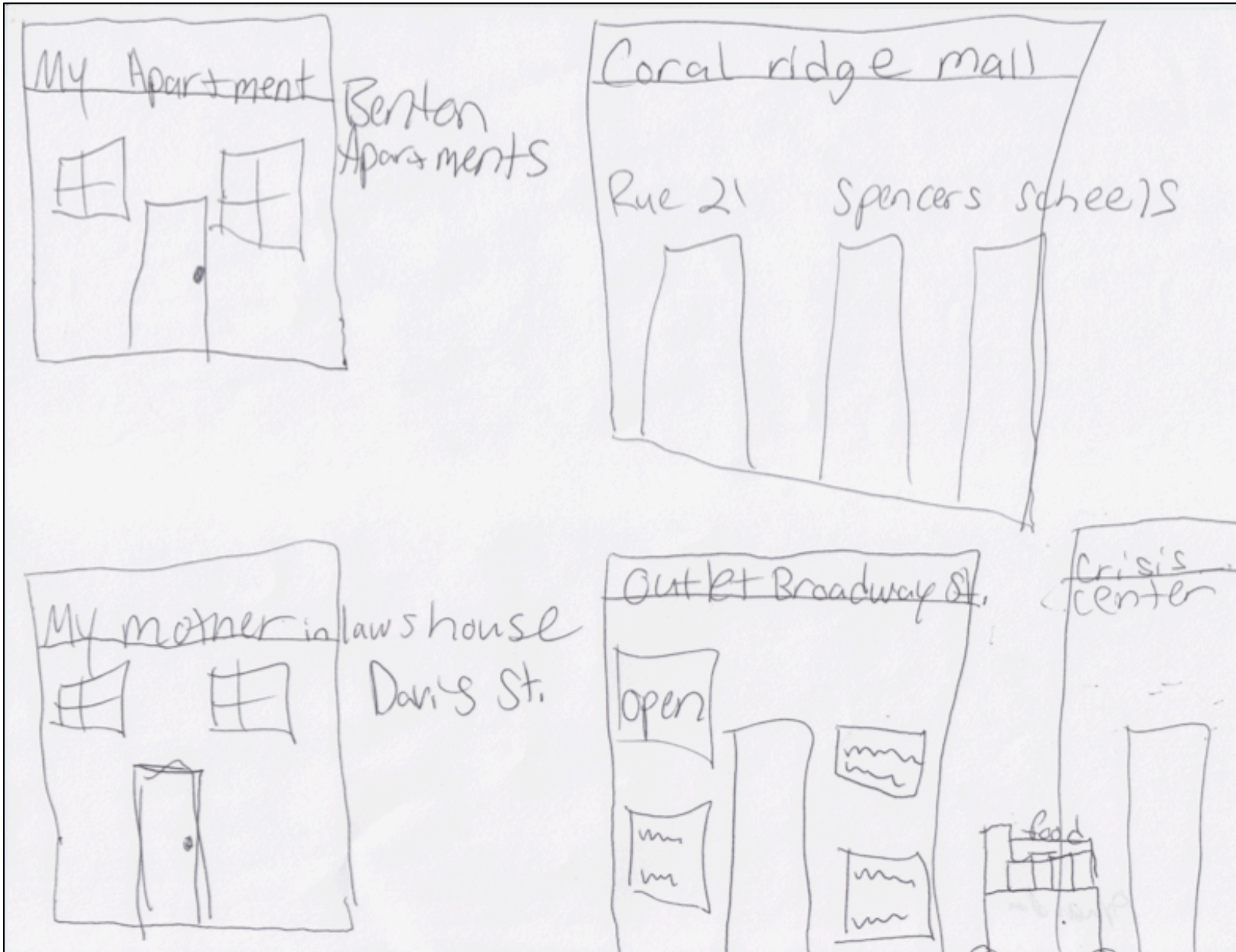

Amanda's Map

Amanda is a black woman who has lived in Iowa for 20 years and in Iowa City for 10 years. Amanda's map identifies specific places that she goes, though about 60 percent of her time is spent in the "Southeast Side." Her map includes her mother's house, the crisis center, the Outlet where she goes to get cigarettes, her apartment, and the Coral Ridge Mall in neighboring Coralville.

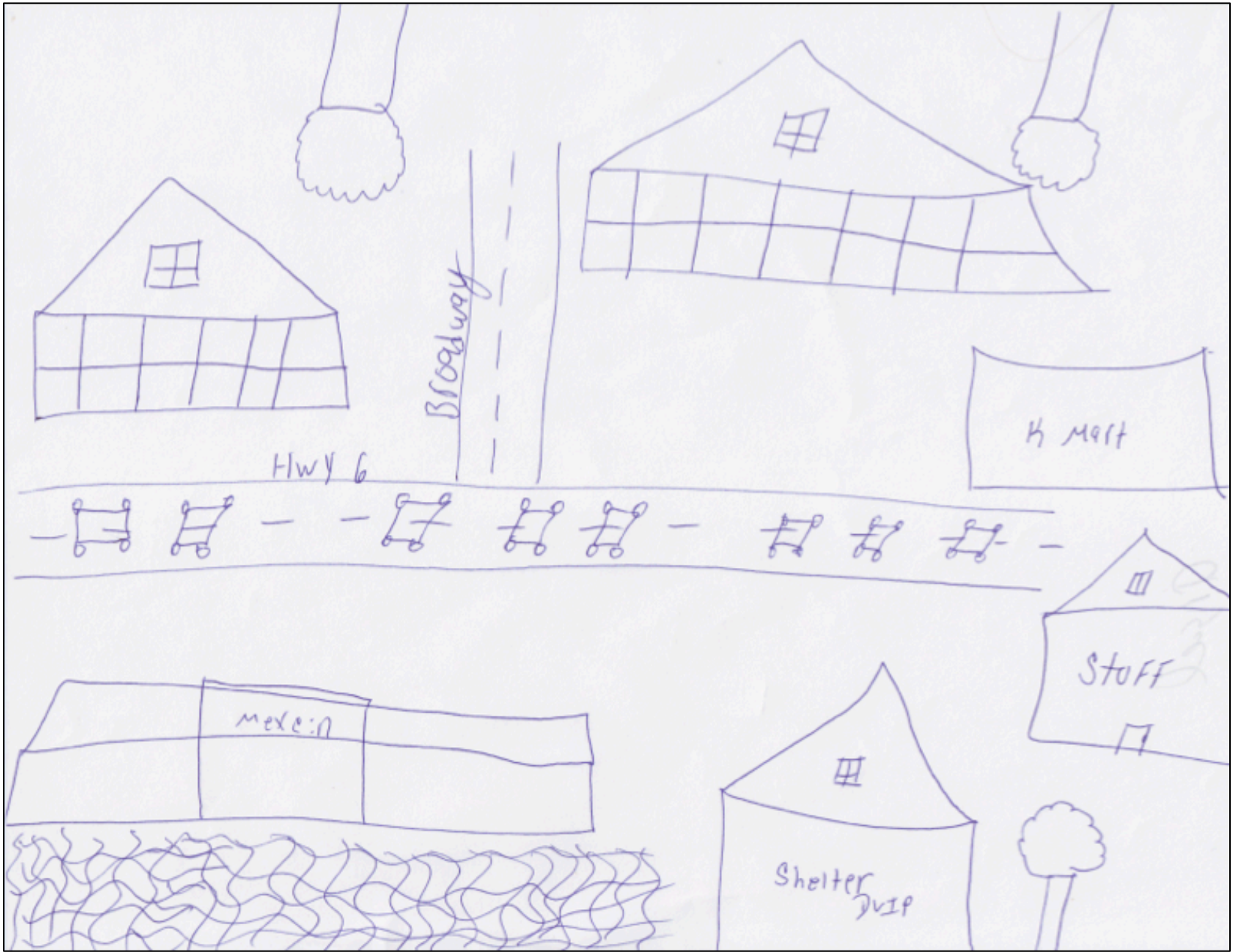

Angel's Map

Angel is a black woman, a community college student, and a mother of three. Her map shows the homeless shelter, Kmart, Stuff Etc. (a discount store), and her former apartment on Broadway Street. She represents two streets, including Highway 6, in the center of her map. Even though it is not shown on her map, Angel says the downtown area is solely for white college students and wealthy people. Angel used to live on Broadway Street, but now lives at a shelter for the domestically abused. Her bottom left corner shows doodling in a parking lot that she made as we spoke.

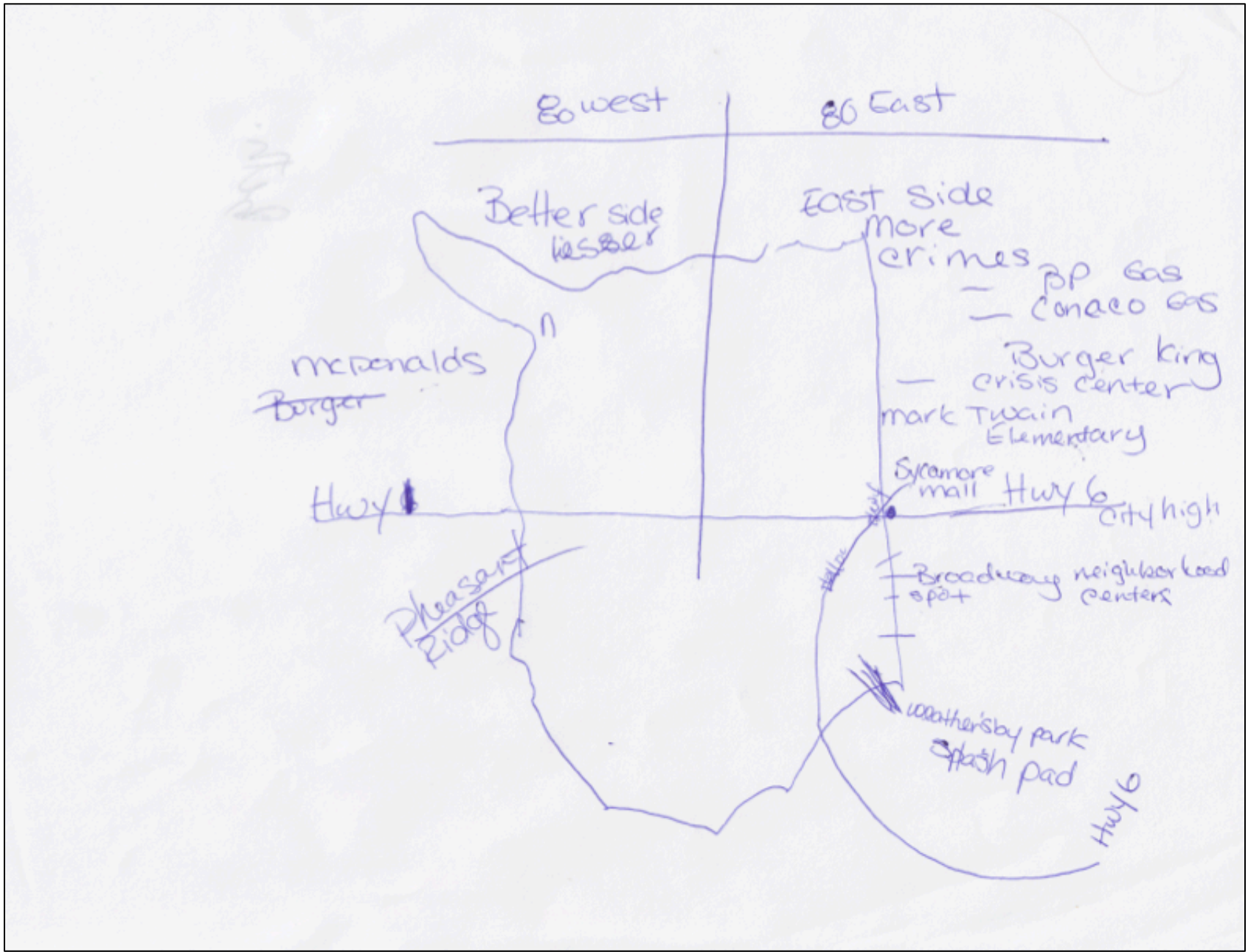

Beth's Map



Beth is a black woman who has lived in Iowa City for the past 10 years. Beth's map shows one side of the city as being "better" than another, that the East Side has "more crimes" and the West Side has "lesser." Beth also lists places that she knows on the map, beginning with Burger King on the East Side and McDonald's on the West Side. She lists schools, the Broadway Neighborhood Center, and a small water feature in a park on the Southeast Side.

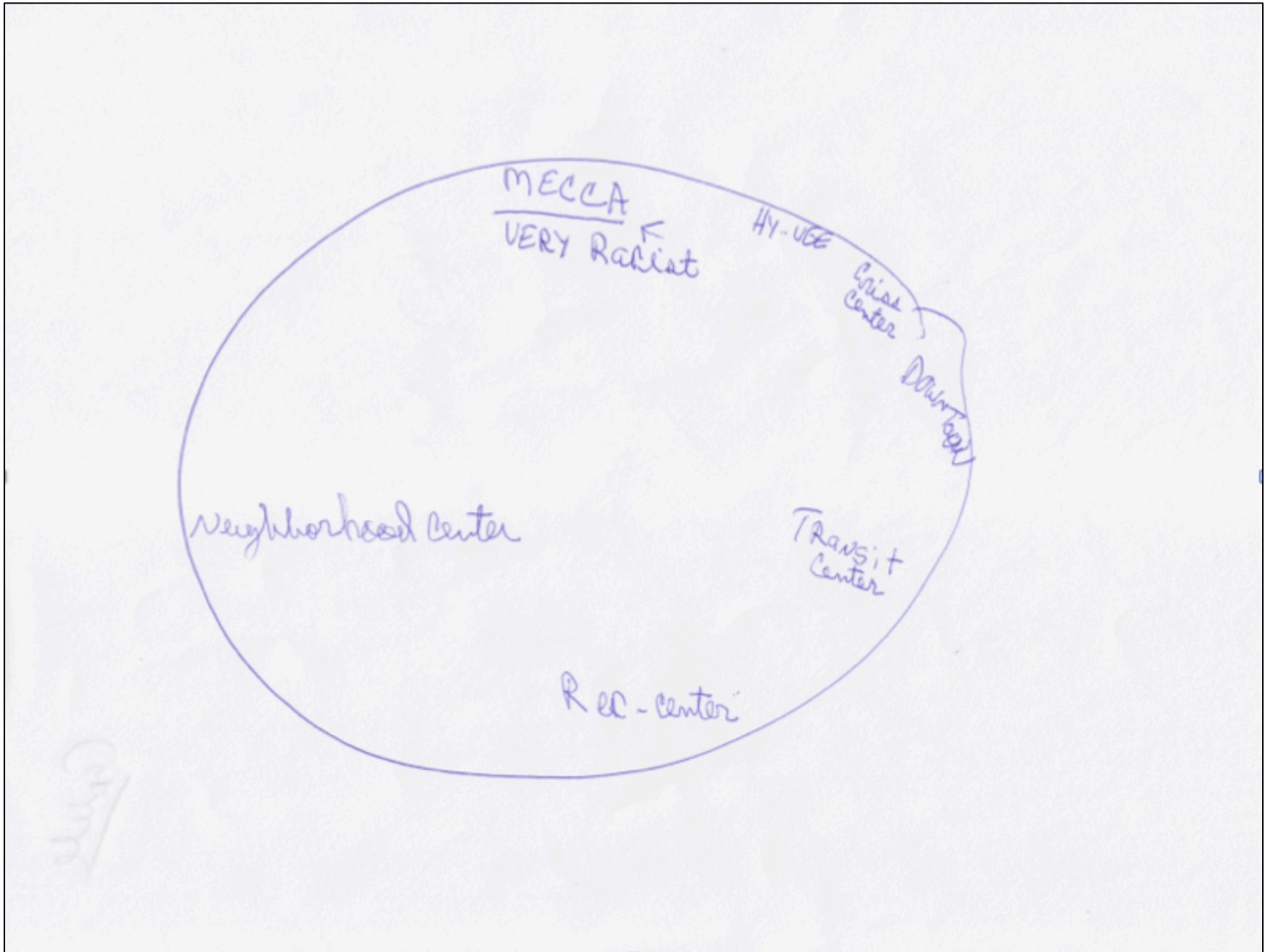

Cordell's Map

Cordell is a black man who has lived in Iowa City for four months, living at MECCA, an addiction treatment center, which is located at the top of his map. Cordell writes that MECCA is “very racist,” but he does not describe what he means by that. Cordell says that he knows little about the city, other than what he sees and where he goes on the bus. He goes to the Crisis Center, downtown, the transit center and the community recreation center, which is also downtown.

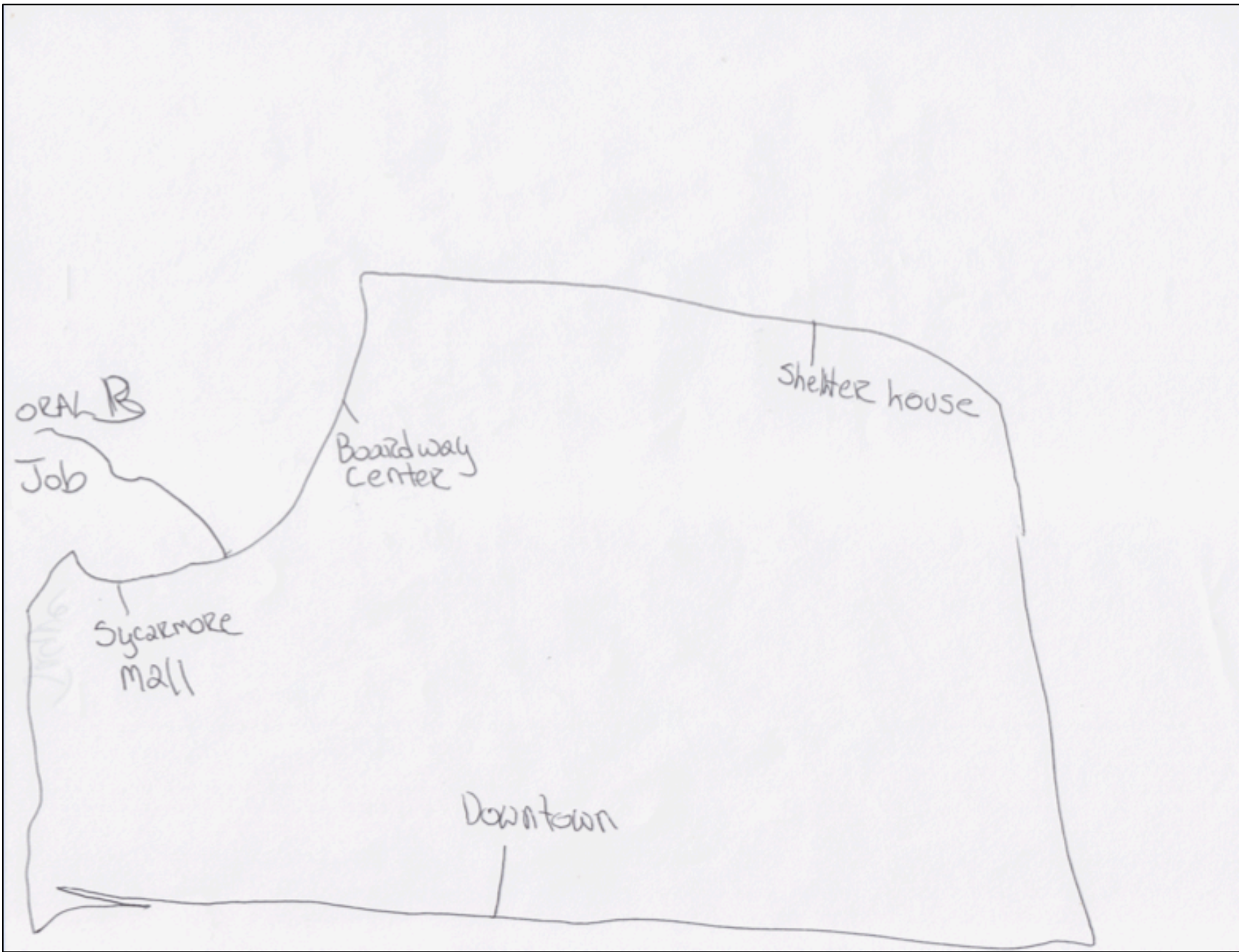

Jacque's Map

Jacque is a black man who has lived in Iowa City for two months. He says that he arrived in the Southeast Side because “this is where people start once they get here.” Jacque’s map follows the bus line, starting at where he is staying, the homeless shelter in the top right. He includes the Broadway Neighborhood Center and Oral B, where he works on a factory line. He also locates the Sycamore Mall and downtown.

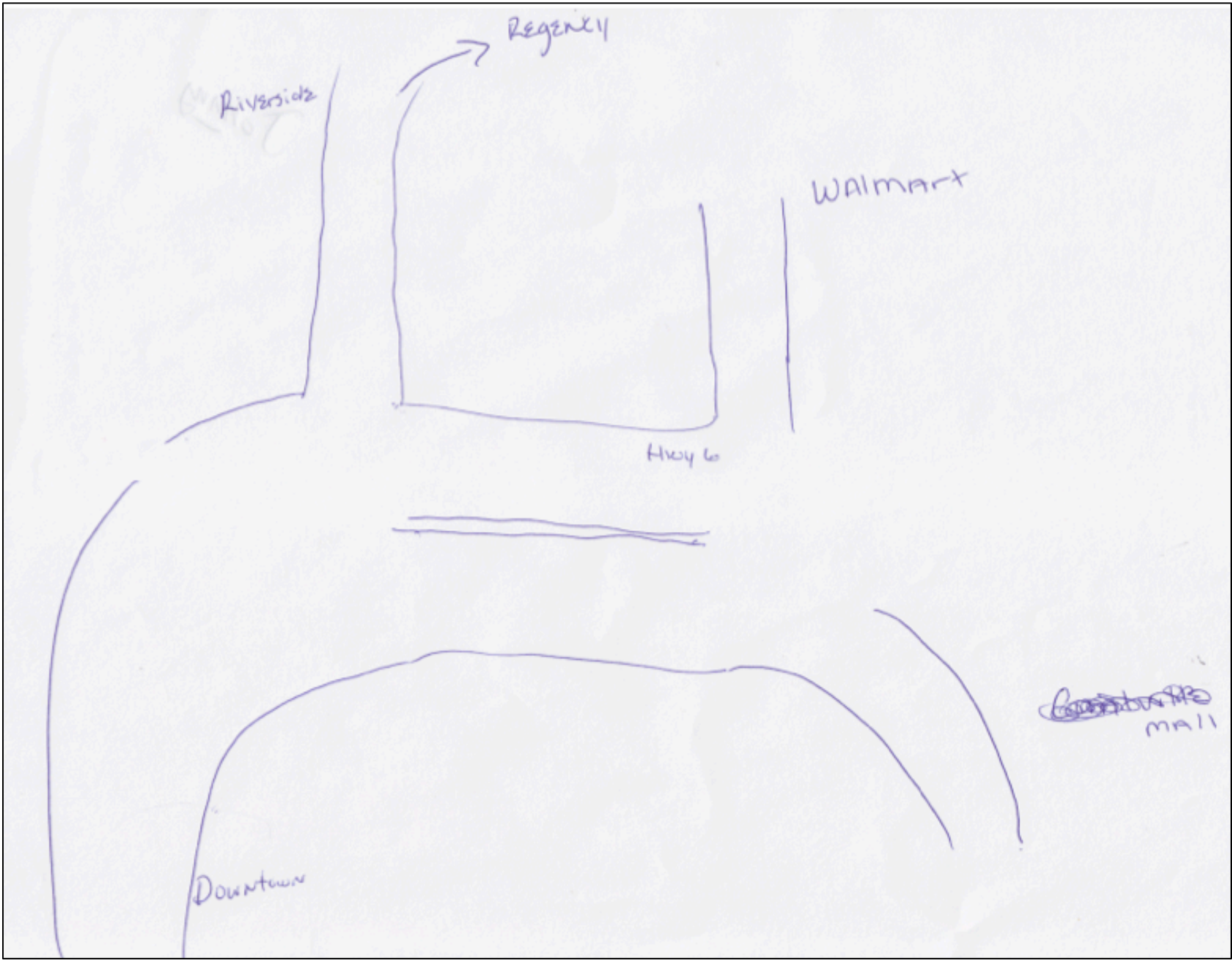

Johnny's Map

Johnny is a black man who has been in Iowa City for more than two years. In Johnny's map, Highway 6 takes up a large part, because it connects him with the downtown (specifically the bus stop there), a mobile home park where he lives south of the city, and Walmart. He says he does not know much about the community, because he travels back and forth between his home, the neighborhood center, and work in North Liberty, a nearby community. He says he often takes the bus or shares a ride with friends.

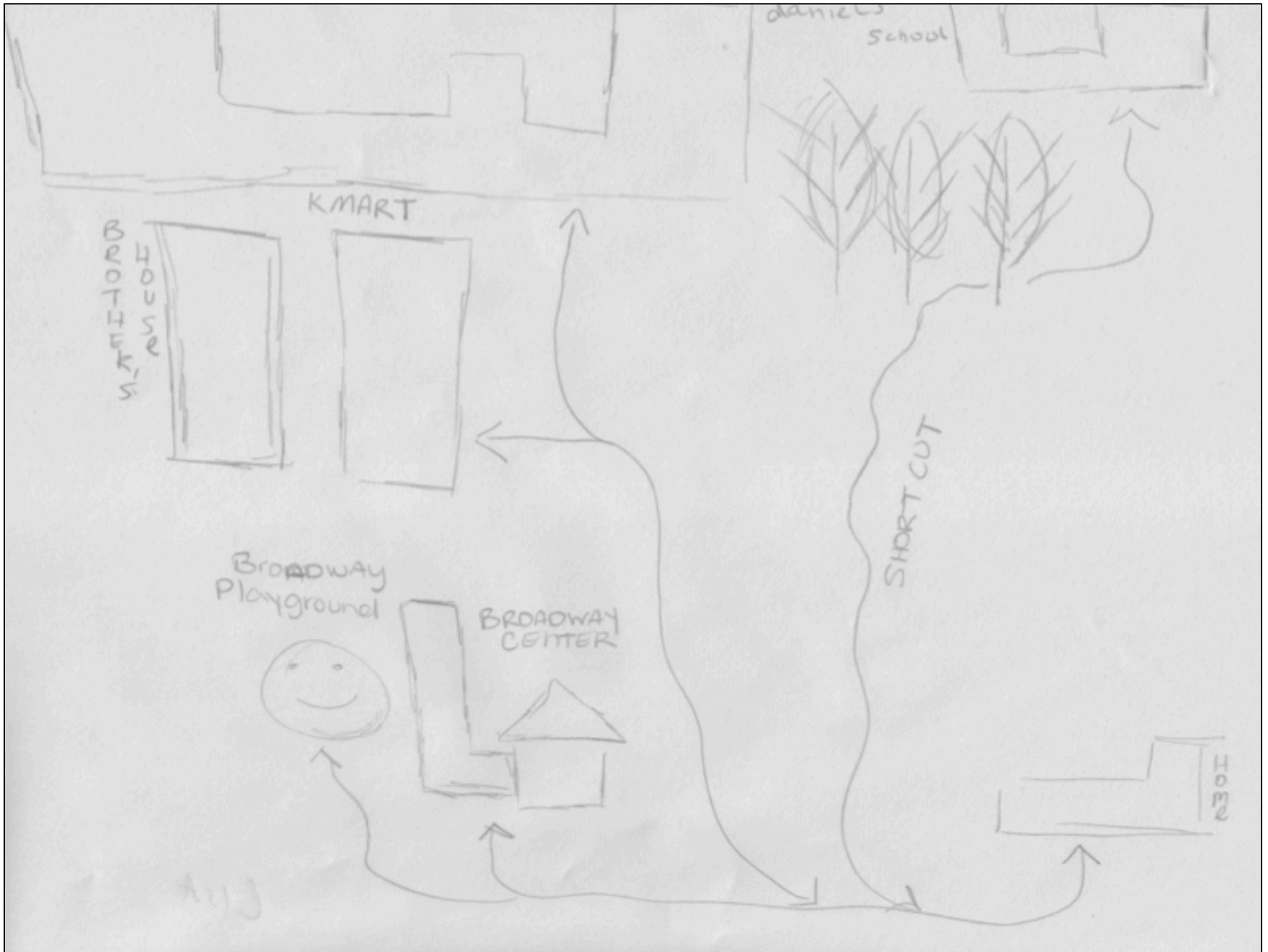

Lisa's Map



Lisa is a black woman who has been in Iowa City for one year. She draws where one of her children goes to school and where another plays at a nearby playground. Lisa draws trees and a shortcut to the school she uses. Kmart is on her map because it is the closest store where she can buy food.

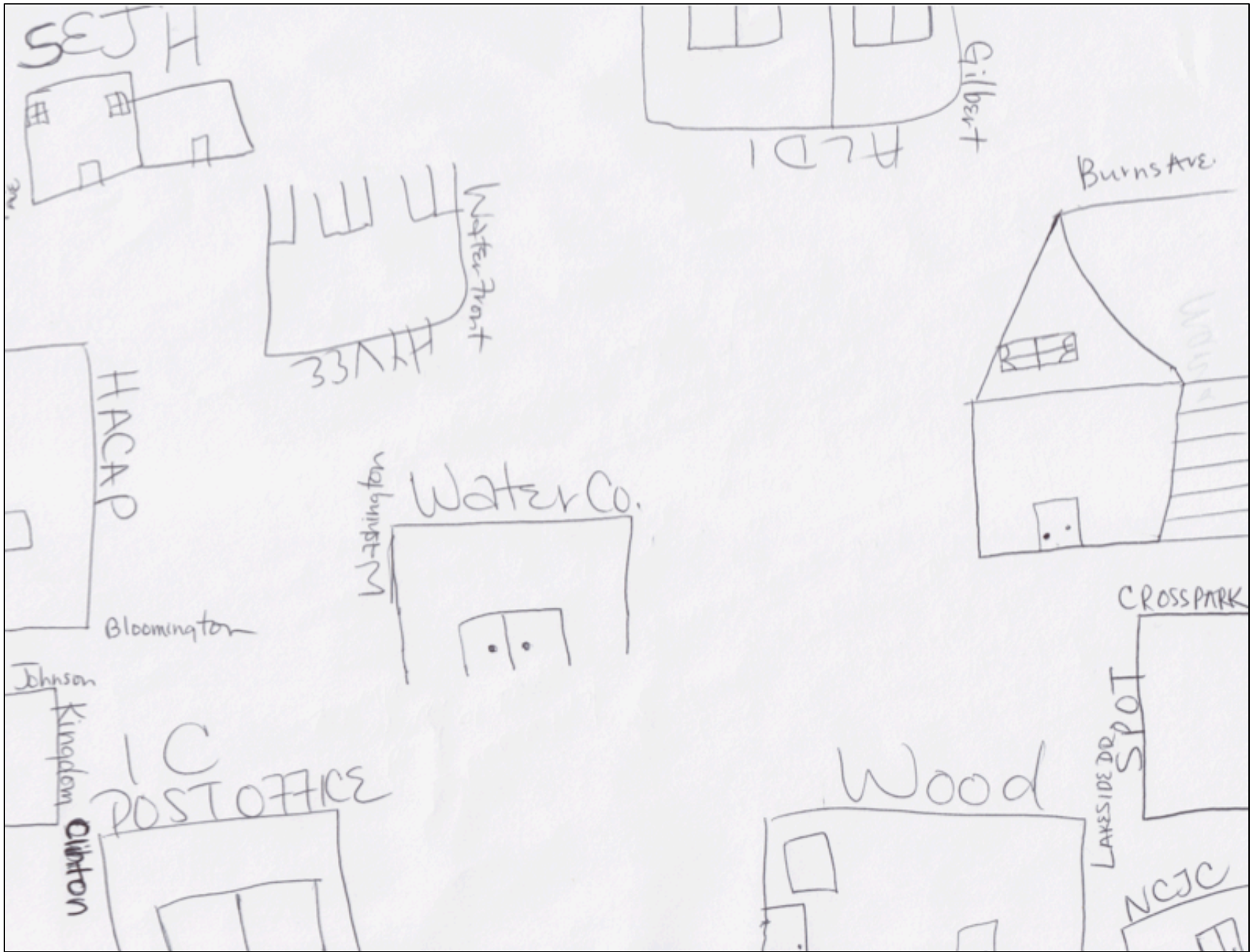

Maria's Map

Maria is a black woman who moved to Iowa City eight years ago. Her map represents the many places she goes in the community, including her church, her children's daycare and school, where she pays the water bill, and her home on Burns Avenue.

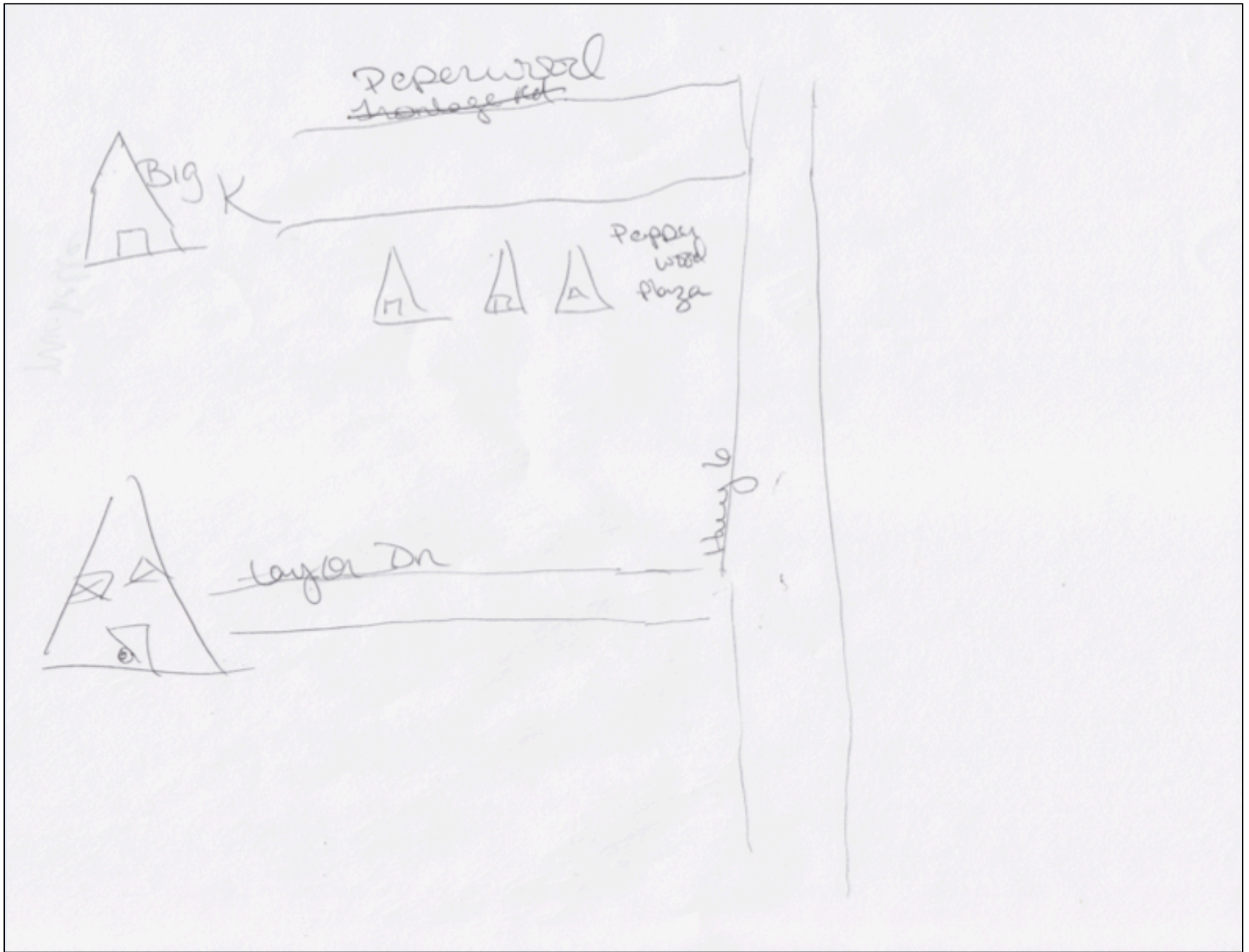

Michelle's Map

Michelle is a black woman who has lived in Iowa City for nine years. She compares Iowa City to Chicago suburbs, which she considers mostly white and middle class. Michelle drew Highway 6, the nearby Pepperwood shopping mall, and her house off of Taylor Drive.

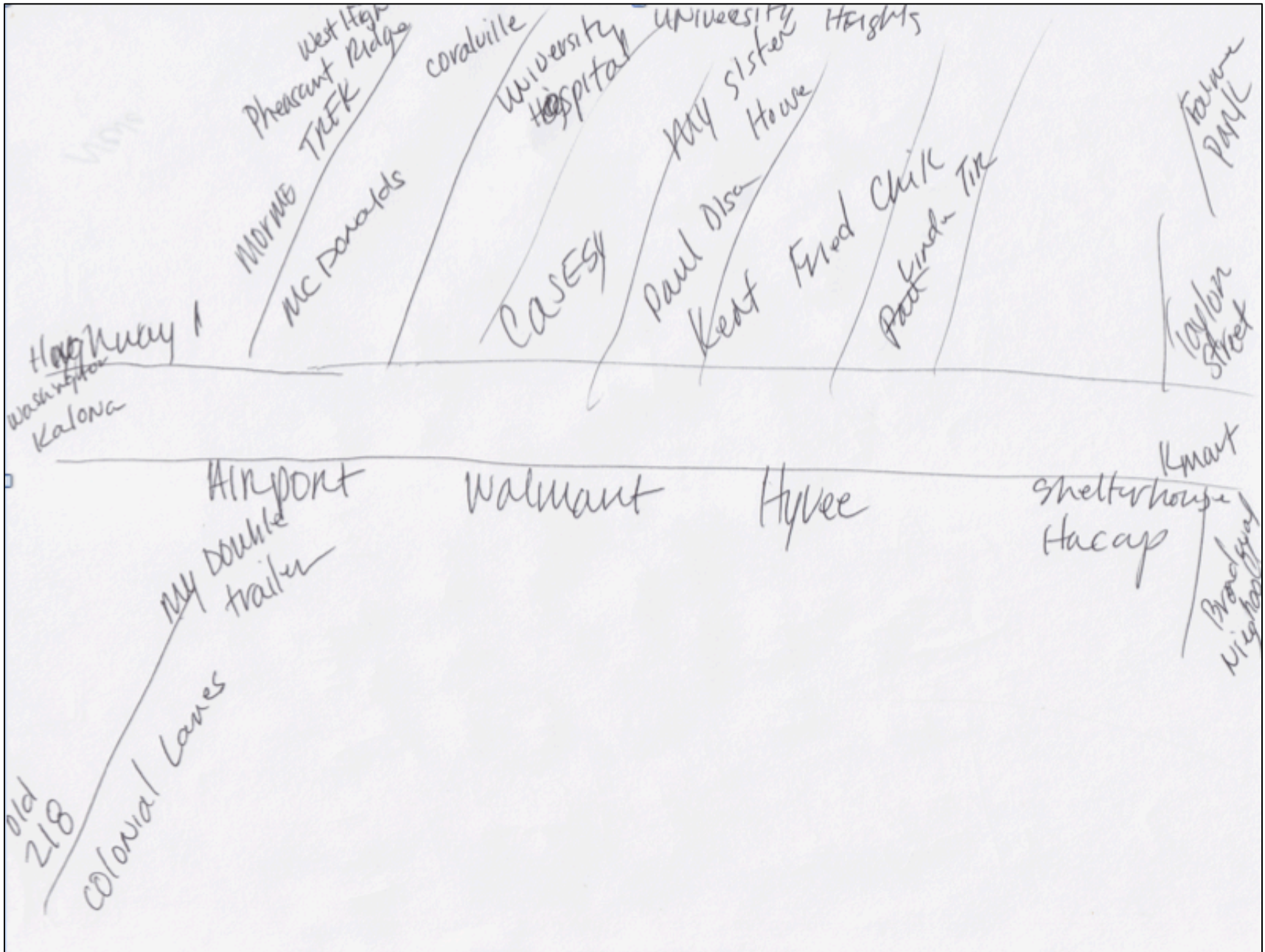

Nene's Map

Nene is a black woman who has been in Iowa for 21 years. About 14 of those years have been in Iowa City. She says the Southeast Side, which takes up most of her map, revolves around Highway 6/1 and isolates residents in the Southeast Side.

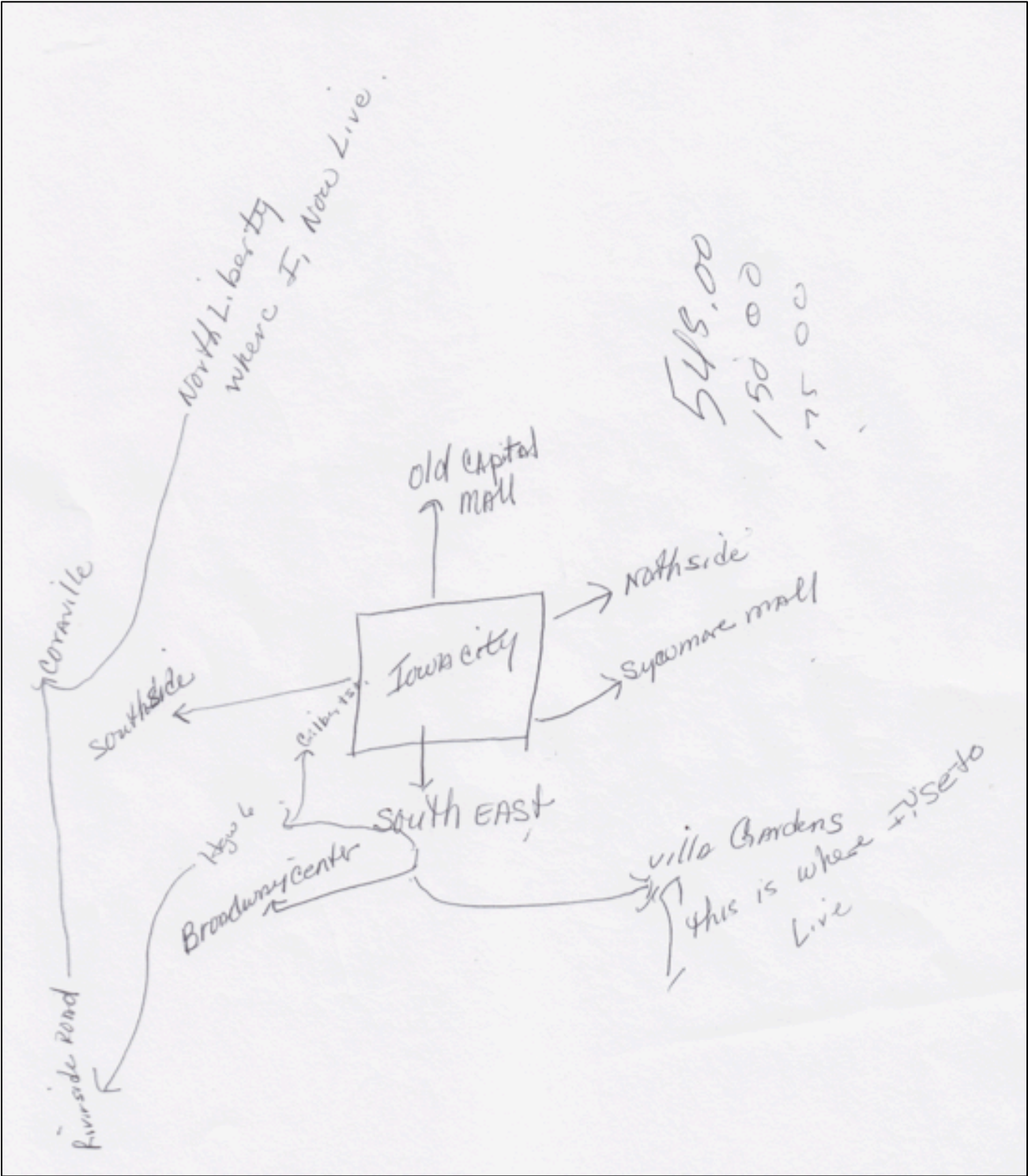

Nevaeh's Map



Nevaeh (Heaven spelled backwards) is a black woman who has been in Iowa City for eight years. She says she wishes the bus system would get her around town so that she “wouldn’t be confined to one place.” On her map, she includes the Broadway Neighborhood Center, her former home at Villa Gardens apartments, and a nearby mall as places that she visits. Nevaeh wrote the numbers on the map when describing how much of a rental security deposit was returned.



Sandra's Map

Sandra is a black woman who has lived in the Iowa City area for 10 years. Sandra works as a custodian at The University of Iowa and uses the bus to travel. Sandra's understanding of Iowa City is constrained by her ability to get around, she said. She drew her apartment, her sister's apartment, and the Iowa River, where she fishes for catfish. Sandra considers the Northeast Side as the business district and where she visits the Social Security office. She also includes the hospital, the Hyvee grocery store, and the Broadway Street Neighborhood Center. Her map's boundary follows the bus line.

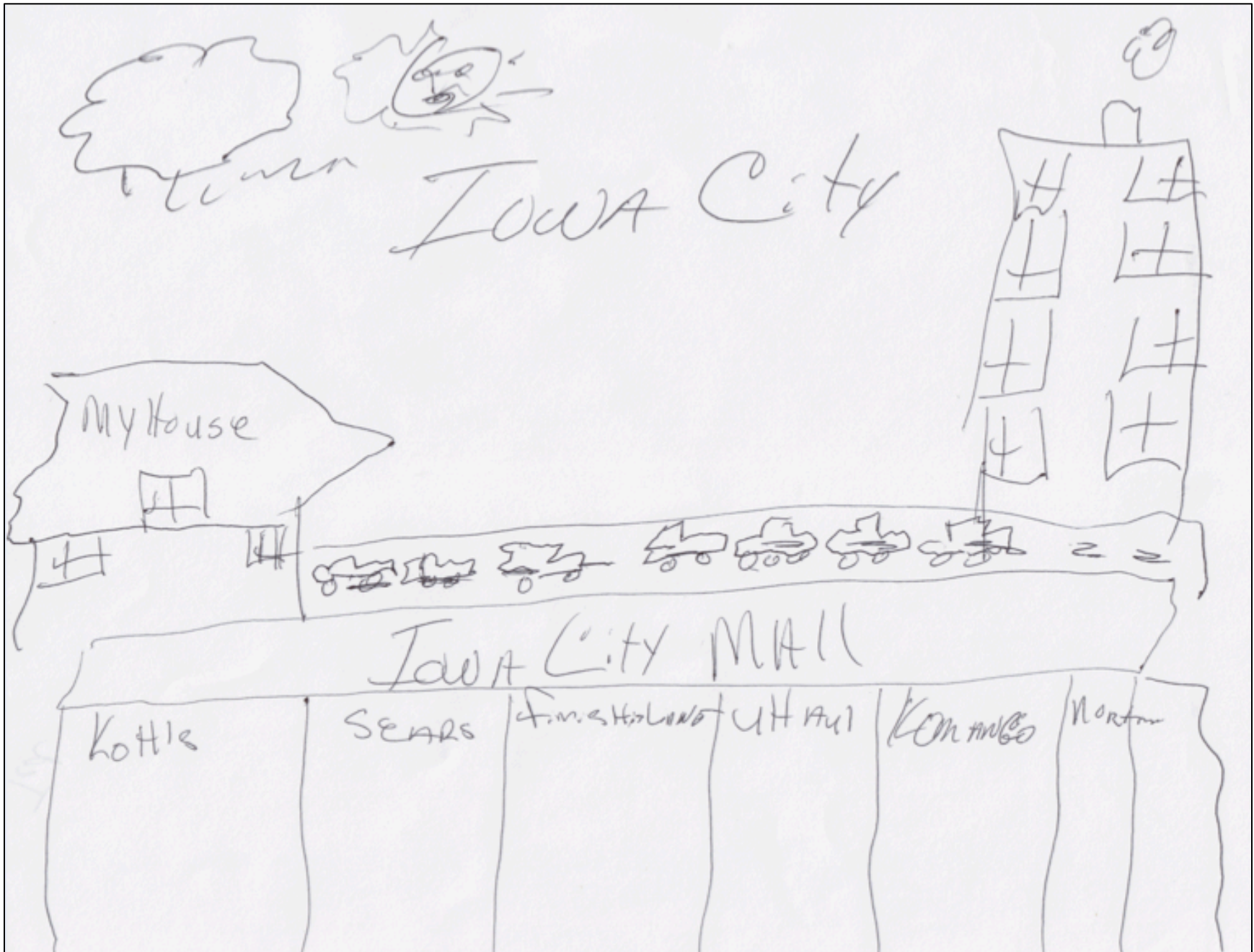

Ted's Map

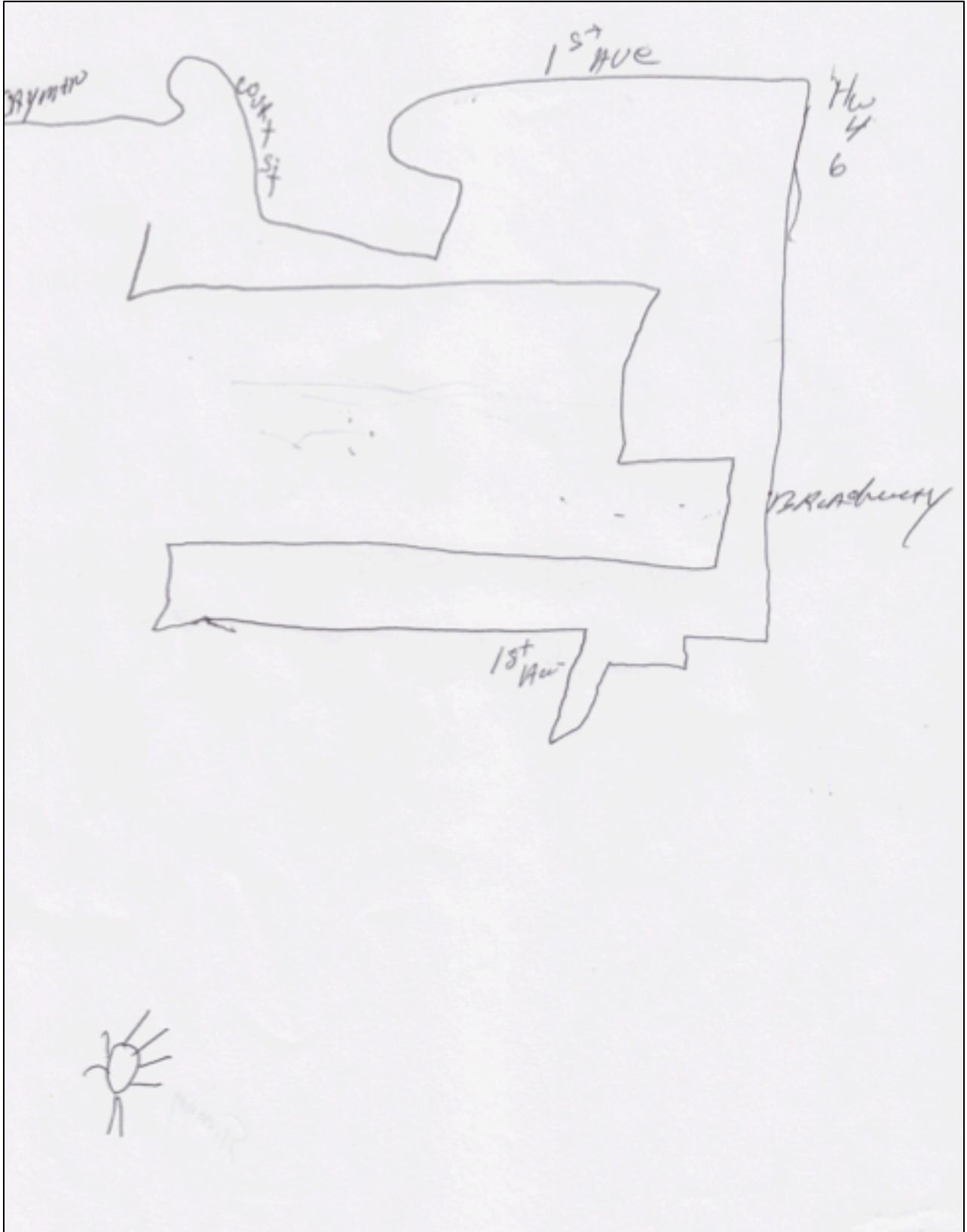

Slimmy's Map

Slimmy is a black man who has been in Iowa City for 20 years. Slimmy's map of Iowa City shows his route to and from the neighborhood center and other spots throughout the town. He says that he spends most of his time at home, with his friends, or transporting members of his family to places in the city.

Ted is a black man who has lived in Iowa City for seven years. In addition to volunteering at the Broadway Street Neighborhood Center, he works at cleaning houses that are being renovated. Ted says that he has a hard time explaining his thoughts of the city neighborhoods, because he does not know much about the city. Ted draws his home, a road that represents the many streets and highways on which he rides his bicycle to get around. He focuses on the courthouse in the top right of the map, his house, and the several stores he sees at the mall, which is in Coralville (not Iowa City, as he indicates).



Tom's Map



Tom is a black man who has lived in Iowa City for two years. Tom's map is very much about the roads that lead through and around Iowa City, which he uses to get to work in North Liberty. Tom says the Southeast Side is a quiet place that is not the ghetto and that the downtown is where to party, where college students are, and where "you get business done." The West Side "is where rich people live." His map details businesses, such as Wendy's, Walmart, and Buffalo Wild Wings.

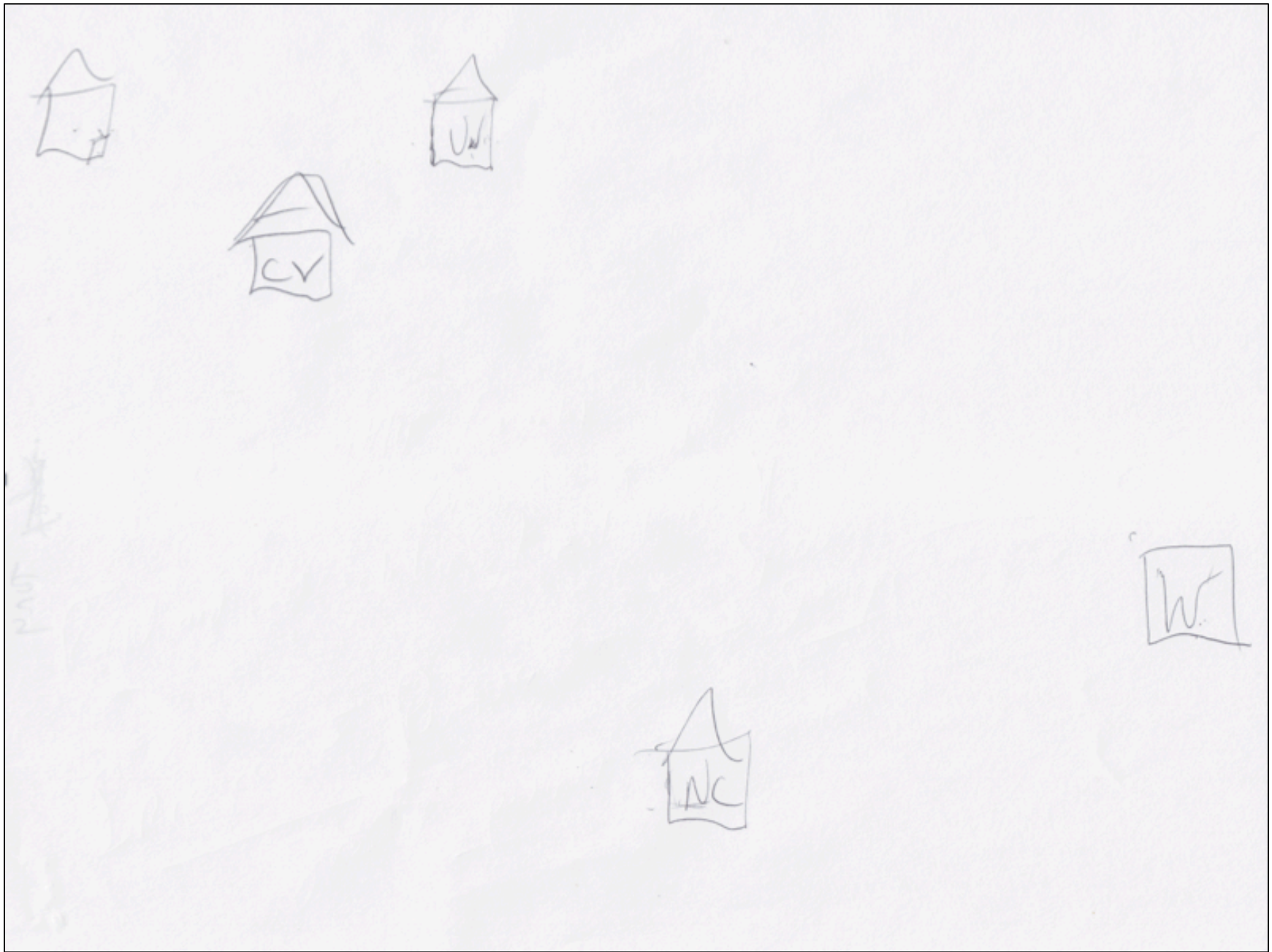

**Tony's Map**

Tony is a black man who has been in Iowa City for nine years. He works in a warehouse. Tony attended Iowa City's West High School and now lives in nearby Coralville (represented by the empty house in the top left). Tony says that he does not go very far from home other than to the Coralville mall (labeled "CV"), to his uncle's home (labeled "UN"), to work (labeled "W"), and to the Broadway Street Neighborhood Center (labeled "NC") where he performs community service.